

Monaro High School

Works notification

28 February 2022

We are continuing the upgrade of Monaro High School to improve the functionality of the school, creating more flexible learning spaces to accommodate new ways of teaching and learning.

Electrical works and changes to pedestrian access

As part of the upgrade works, a new substation will be installed at Monaro High School in the area next to the new performing arts centre (PAC) and the pedestrian entrance to Building H (see diagram overleaf). The substation will upgrade the school's power supply and is required as part of the project to upgrade Monaro High School.

The works will take place from Thursday 3 March 2022 until Tuesday 31 May 2022, weather permitting.

During these works, construction vehicles will enter and exit the site through the Mittagang Road entrance. The school entrance to Building H on Mittagang Rd will be closed to pedestrians and a protective barrier will be put in place across the entrance. Students and staff will be redirected to the school entrance on Yanni Street.

There will be no change to the school drop off area on Yanni Street.

Construction hours

The standard construction hours for this project are 7 am to 5 pm Monday to Friday and 8 am to 4 pm Saturday. No work will take place on Sunday or public holidays, unless otherwise notified.

The health, safety and wellbeing of students, staff, neighbours and community is our highest priority. For any queries relating to this work, please contact School Infrastructure NSW using the contact details below.

Thank you for your patience and cooperation during these important works.

For more information contact:

School Infrastructure NSW
Email: schoolinfrastructure@det.nsw.edu.au
Phone: 1300 482 651
www.schoolinfrastructure.nsw.gov.au

Site map showing traffic management for the Monaro High School upgrade

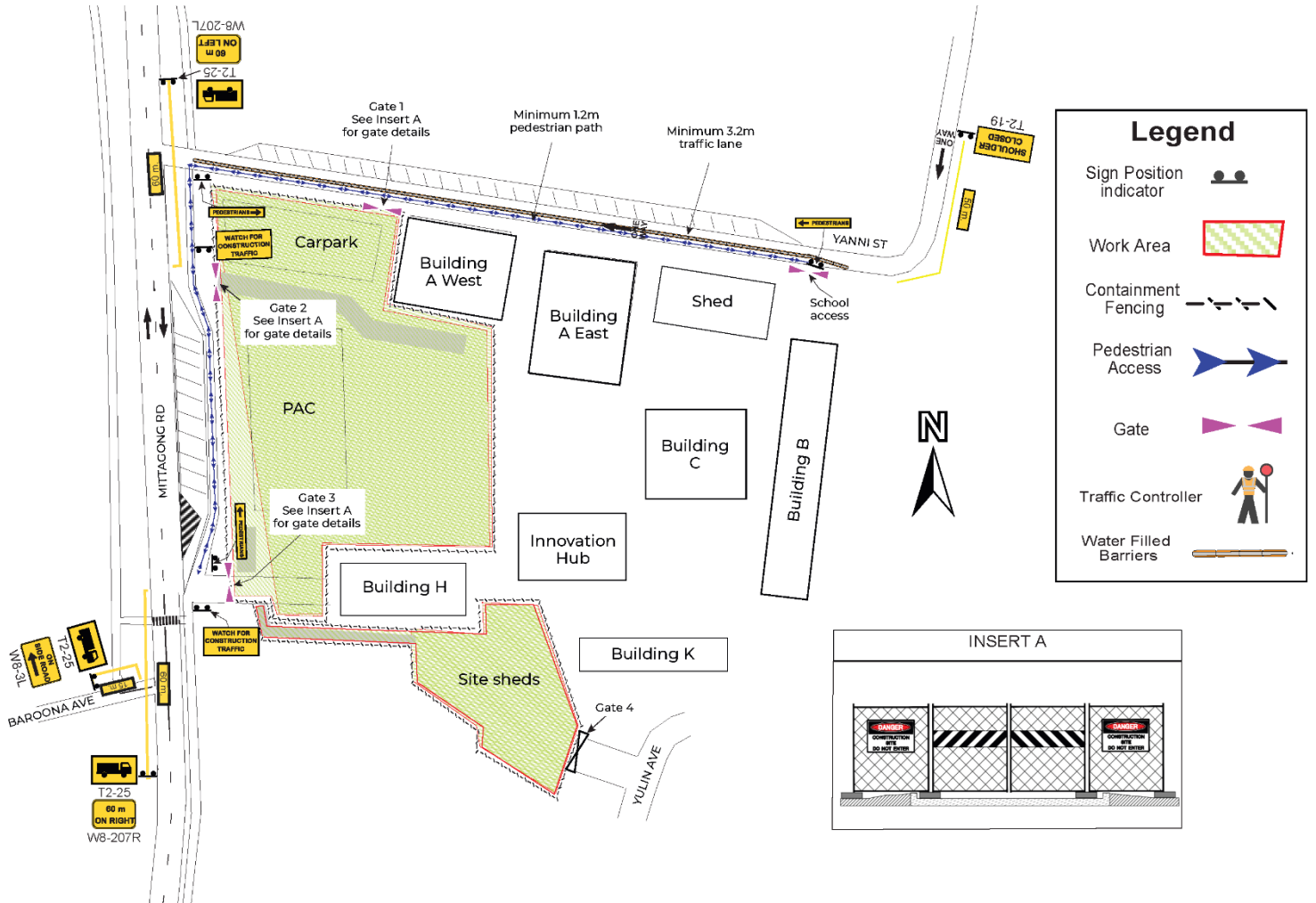

For more information contact:

School Infrastructure NSW
 Email: schoolinfrastructure@det.nsw.edu.au
 Phone: 1300 482 651
www.schoolinfrastructure.nsw.gov.au

